



LOGISTECH

LogisTech is an integrated logistics development comprising a three-storey warehouse and a four-storey ancillary office paired with an adjoining two-storey warehouse block. The property is credited as Singapore's first logistics building to receive the BCA Green Mark Platinum Super Low Energy Award.

With both warehouse and ancillary office facilities onsite, the property enables businesses to co-locate their offices with their warehouse operations.

LogisTech is well connected via the Pan-Island Expressway (PIE) and East Coast Parkway (ECP). It is located a 10-minute drive from Singapore Changi Airport, Singapore Expo, and Changi Business Park.

3 Changi North Street 2
LogisTech
Singapore 498827





ACCESSIBILITY

- 5-minute drive to the Pan-Island Expressway (PIE) and East Coast Parkway (ECP)
- Easily accessible to Singapore Changi Airport

BUILDING SPECIFICATIONS

Type of Building

- Integrated logistics development comprising:
 - 3-storey warehouse
 - 4-storey ancillary office building with an adjoining 2-storey warehouse
- BCA Green Mark Platinum Super Low Energy Award
- Green features: High-efficiency multi-tiered chiller plant, air-conditioning system, and intelligent lighting control

Floor Area

- Total NLA: Approx. 30,177 sqm

Floor Loading

- Main building
 - Ancillary office
 - 1st to 3rd storeys: 5.0 kN/sqm
 - Warehouse
 - 1st storey: 20 kN/sqm
 - 3rd storey: 7.5 kN/sqm to 20.0 kN/sqm
 - 4th storey: 7.5 kN/sqm
- Extension block (#01-05, #03-05)
 - Warehouse
 - 1st & 3rd storeys: 20.0 kN/sqm
 - 3rd storey: 12.5 kN/sqm (Post-extension area beside emergency exit)

Ceiling Height (Maximum Height)

- Floor-to-floor
 - Main building
 - Ancillary office
 - 1st to 3rd storeys: 4.0 m
 - Warehouse
 - 1st & 4th storeys: 8.0 m
 - 3rd storey: 4.0 m to 8.0 m
 - Extension block
 - Warehouse
 - 1st storey: 8.0 m
 - 3rd storey: 9.0 m

Lifts

- Passenger lifts: 2 x 1,020 kg (15 persons)
- Cargo lifts
 - 4 x 2,500 kg
 - Dimensions: 3.0 m (W) x 3.0 m (D) x 2.3 m (H)
 - Lift car door size: 2.0 m (W) x 2.3 m (H)
 - 1 x 5,000 kg (Access at #01-04)
 - Dimensions: 3.0 m (W) x 3.5 m (D) x 2.6 m (H)
 - Lift car door size: 2.5 m (W) x 2.6 m (H)

Loading Bay Facilities

- 16 loading/unloading bays with 12 dock levellers

Parking Lots

- Car: 189
- Motorcycle: 35

Provisions

- 24-hour security surveillance at common area
- Closed circuit TV system

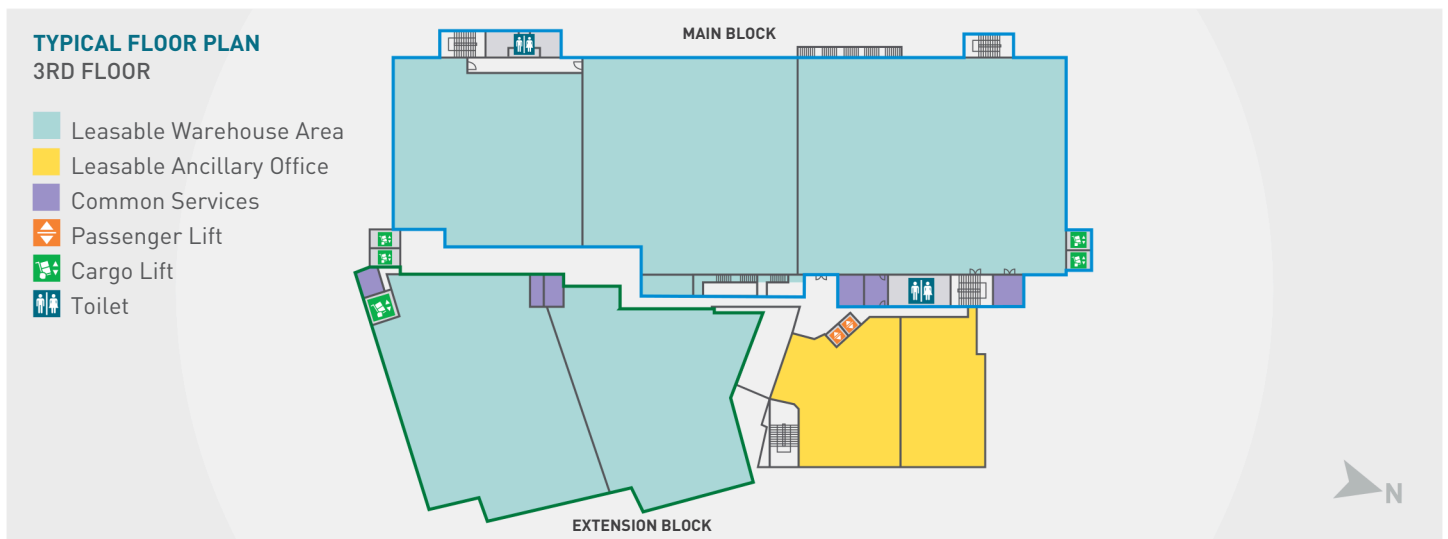

Leasing Enquiries [✉ sg.marketing@capitaland.com](mailto:sg.marketing@capitaland.com) [☎ 6508 8686](tel:65088686) [☎ 9757 7000](tel:97577000) (message-only service available on weekdays from 8.30am to 6pm)

Disclaimer

The Developer makes no representations or warranties, conditions, undertakings or terms either expressed or implied as to the condition, quality, accuracy, fitness for purpose, completeness of the information contained herein or that such information will be accurate, up to date, or free from error. All art renderings and pictures herein are artist's impressions only and all specifications stated herein are subject to re-survey and approval from the relevant authorities. The information and specifications contained herein do not form part of an offer or a contract and neither the Developer nor their appointed Marketing Agents can be held for any inaccuracies, changes, losses or damages arising therefrom.